

Sealant can be used instead of screws,  
or in addition to create a higher level of  
impermeability

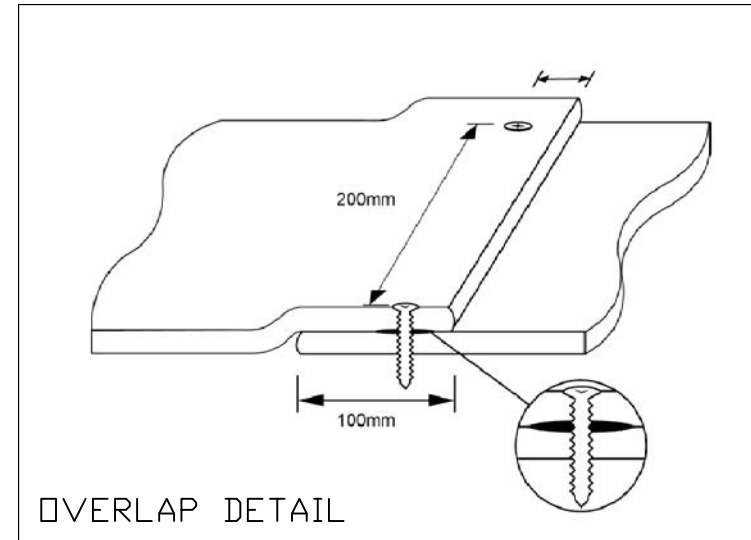

NOTES:

**TO BE USED FOR ILLUSTRATIVE  
PURPOSES ONLY.**

**ALL PRODUCTS TO BE LAID IN  
ACCORDANCE WITH  
MANUFACTURERS  
RECOMMENDATIONS.  
INSTALLATION TO BE CARRIED  
OUT BY TRAINED OPERATIVES  
AND SUPPORTED THROUGH  
ONSITE MONITORING AND  
TESTING.**

**SPACINGS BETWEEN  
CONSTRUCTION MATERIALS  
EXAGGERATED TO INDICATE  
DETAILS MORE CLEARLY.**

LEGEND:

— Concrete Canvas

TITLE:

**5.3.1 - CC Layout - Slope Protection**

DRAWING NUMBER:

**CC-L-SP-001-REV4**

DATE:

**19/10/2017**

VERSION:

**04**

SCALE:

**NOT TO SCALE.**

PRODUCED BY:

**CONCRETE CANVAS LTD.**

**CONCRETE CANVAS LTD.**  
UNIT 3, BLOCK A22, SEVERN RD.  
TREForest INDUSTRIAL ESTATE,  
PONTYPRIDD, CF375SP  
UNITED KINGDOM

TEL: +44 (0)345 680 1908  
EMAIL: [INFO@CONCRETECANVAS.COM](mailto:INFO@CONCRETECANVAS.COM)

Please note: As each customer's use of our product may be different, information we provide, including without limitation recommendations, test results, samples, care/labelling/processing instructions or marketing advice, is provided in good faith but without warranty and without accepting any responsibility. Each customer must test and be responsible for its own specific use, further processing, labelling, marketing etc. All sales are exclusively subject to our standard terms of sale document, available at [www.concretecanvas.com](http://www.concretecanvas.com). (All additional/other terms are rejected) unless explicitly agreed otherwise in a signed writing.

CC laid vertically down slope,  
overlapped by 100mm (in the  
direction of water flow, if applicable)  
and screwed along joint every  
200mm with stainless steel screws.

CC buried or anchor  
trenched at crest to  
prevent undermining

CC pegged at crest  
with min. 250mm pegs

Additional pegs may be  
required on face of slope  
for profiling depending on  
degree of undulation

Typical  
Anchor Trench Section

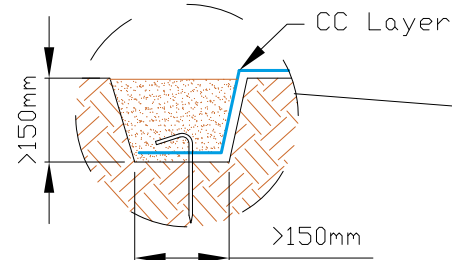

Backfilled anchor trench to side slopes are required  
to prevent wind or water ingress. Where it is not  
possible to create an anchor trench, the Concrete  
Canvas should be fixed to prevent the risk of uplift  
or undermining/erosion. For advice on appropriate  
fixing please contact Concrete Canvas.

CC pegged at toe with  
min. 250mm pegs

CC laid into toe drain or used to  
form V-ditch at base of slope  
overlaid in direction of water flow.

# CC Layout – Slope Protection